

Mechanical Dimensions

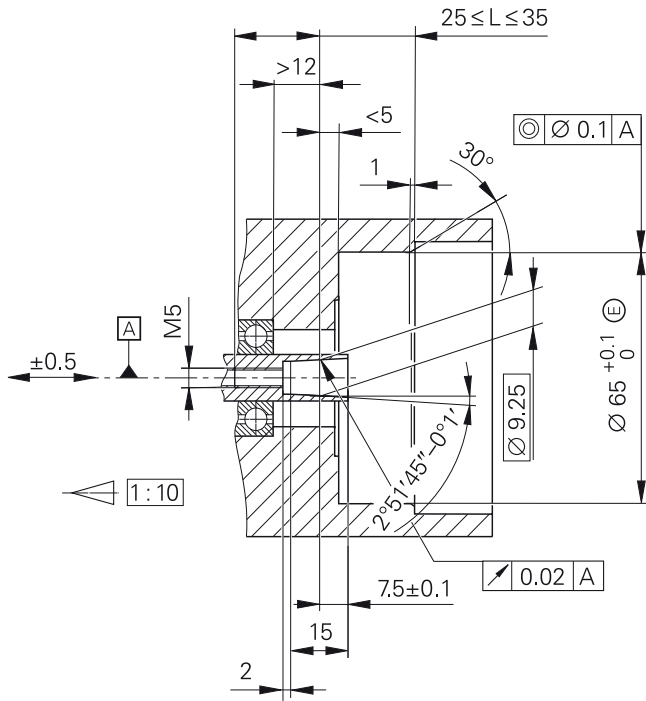

Features

- Compact robust motor integration
- 1Vpp / 1PPR accurate position information
- 2048 PPR sin cosine accurate speed information
- Installation diameter 65mm
- 1:10 taper shaft
- IP67 protection class

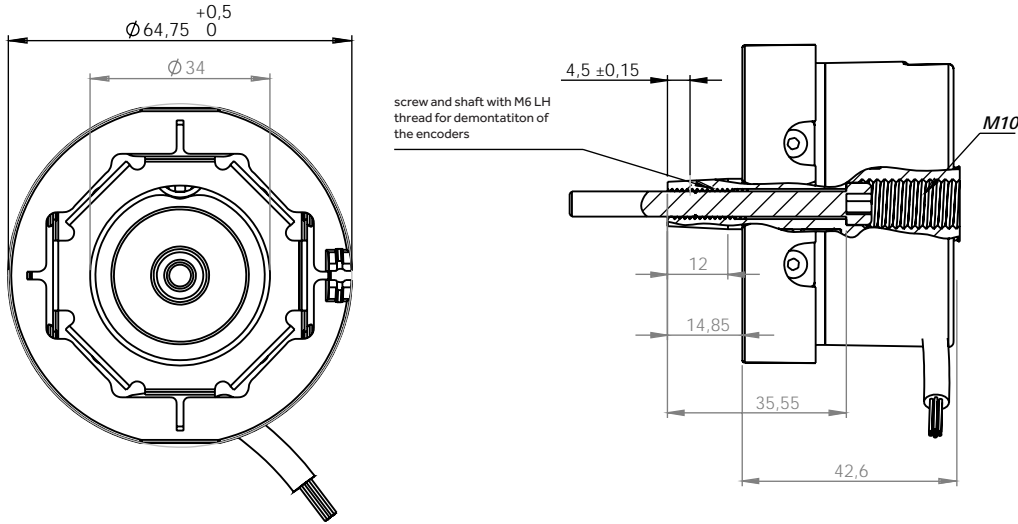

Pulse Diagram

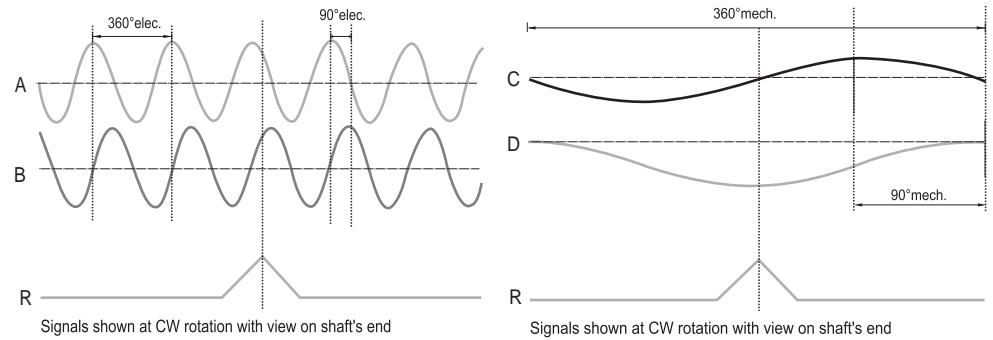

Cable / Connector Wiring

	Function	FNC SC2048-R7 (Direct 7 meter cable)	FNC SC2048 R03-2D15	FNC SC2048 R7-3D15	FNC SC2048 R03-3D15
POWER	+VB	Brown	Kahverengi	pin 9	pin 9
	GND	White	Beyaz	pin 11	pin 7
INCREMENTAL SIGNALS	A	Green	Yeşil	pin 1	pin 5
	A'	Green-Black	Yeşil-Siyah	pin 2	pin 6
	B	Yellow	Sarı	pin 3	pin 8
	B'	Yellow-Black	Sarı-Siyah	pin 4	pin 1
	Z	Gray	Gri	pin 12	pin 3
	Z'	Gray-Black	Gri-Siyah	pin 13	pin 4
ABSOLUTE SIGNALS	C	Blue	Mavi	pin 5	pin 10
	C'	Blue-Black	Mavi-Siyah	pin 6	pin 11
	D	Orange	Turuncu	pin 7	pin 12
	D'	Orange-Black	Turuncu-Siyah	pin 8	pin 13
Shield	Connected to housing				

Montage Steps

- 1** Place the encoder to the motor taper shaft.

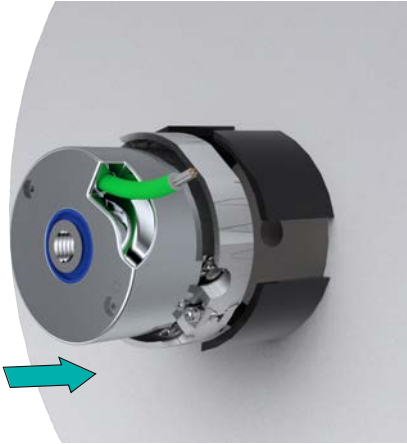

- 2** Insert M5 screw to fix the encoder.



M5\*55 IMBUS

- 3** Use the allen key to turn M5 screw.

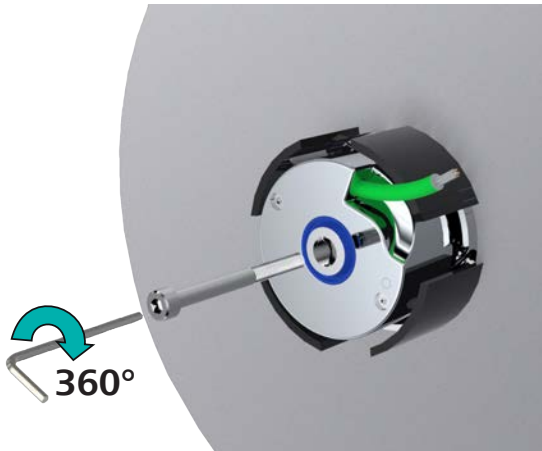

- 4** Use the allen key to fix M2,5 screw in the encoder ring.

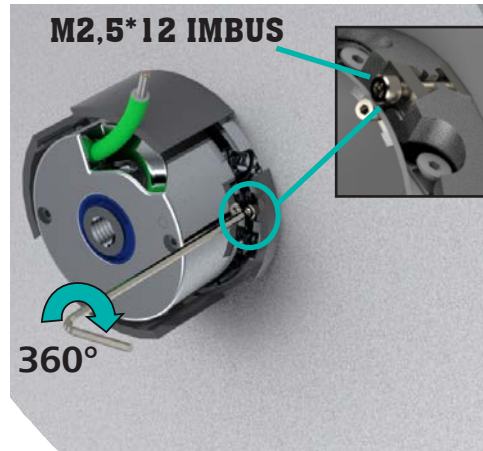

M2,5\*12 IMBUS



Demontage Steps

- 1** Turn the M2,5\*12 screw 360° to loosen the encoder spring

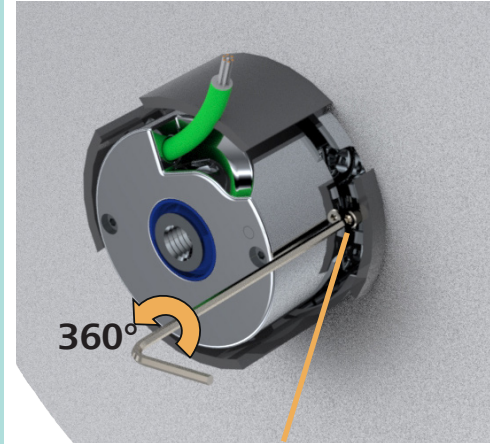

M2,5\*12 IMBUS

- 2** Turn allen key 360° to loosen M5 screw.

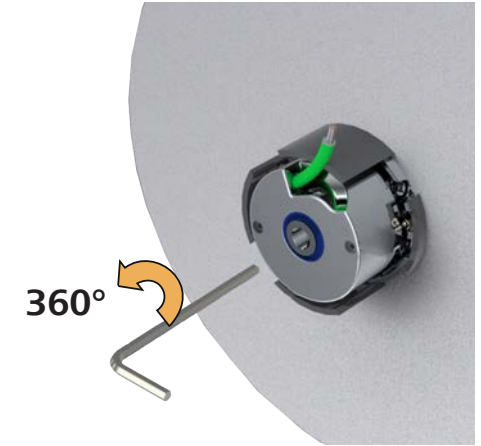

- 3** Place M10 screw to taper shaft. M5\*55 imbus screw stays inside of the shaft.

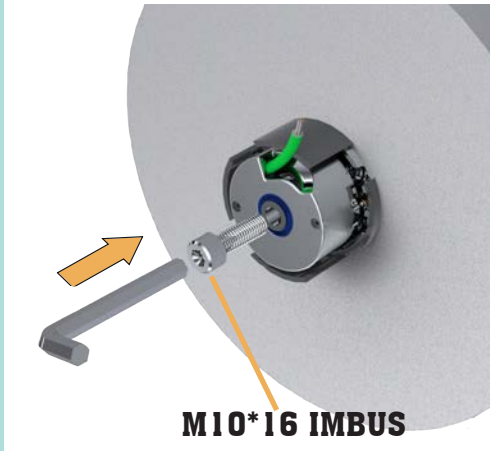

M10\*16 IMBUS

- 4** Turn the M10 screw only far enough in to release the M5 screw.

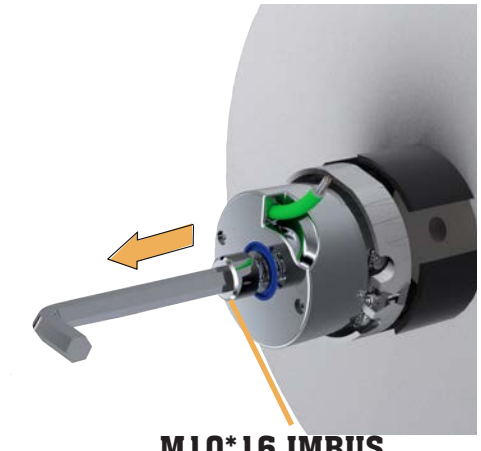

M10\*16 IMBUS

